

## 0.5A to 6A, 250VAC EMI Filters

### Features

- ◆ High Voltage Pulse Attenuation
- ◆ Lug or Wire Terminations
- ◆ Low Earth Leakage Current Option
- ◆ Conforms to UL, CSA and
- ◆ EN Safety Agency Certifications

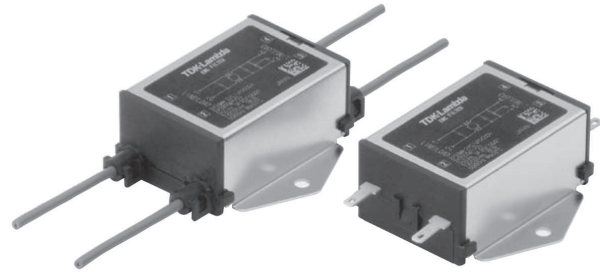

### Key Market Segments & Applications



### Specifications

Model	RSAL-20R5W / RSAL-20R5A / RSAL-20R5WL / RSAL-20R5AL RSAL-2001W / RSAL-2001A / RSAL-2001WL / RSAL-2001AL RSAL-2002W / RSAL-2002A / RSAL-2002WL / RSAL-2002AL RSAL-2003W / RSAL-2003A / RSAL-2003WL / RSAL-2003AL RSAL-2006W / RSAL-2006A / RSAL-2006WL / RSAL-2006AL						
	Rated Voltage (AC, DC)	V	250V				
Rated Current	A	0.5A	1A	2A	3A	6A	
Withstand Voltage	V	Terminals to Case: 2500VAC (1 Minute)					
Isolation Resistance	MΩ	100MΩ minimum (500VDC, 1 Minute)					
Leakage Current (max)	A	RSAL-20xxx 1mA; RSAL20xxxL 10uA (250VAC, 60Hz)					
DC Resistance (total)	mΩ	700	600	250	150	80	
Operating Temperature	°C	-25 to +85°C (Derate above 55°C, see derating curve)					
Storage Temperature	°C	-25 to +85°C					
Safety Agency Certifications	-	UL1283, CSA C22.2 No.8, EN60939					
Weight	g	61g Maximum					
Warranty	yr	1 Year					

### Options

Wire Terminations	RSAL-20xxW
Lug Terminations	RSAL-20xxA
Wire Terminations & Low Leakage Current	RSAL-20xxWL
Lug Terminations & Low Leakage Current	RSAL-20xxAL

### Derating

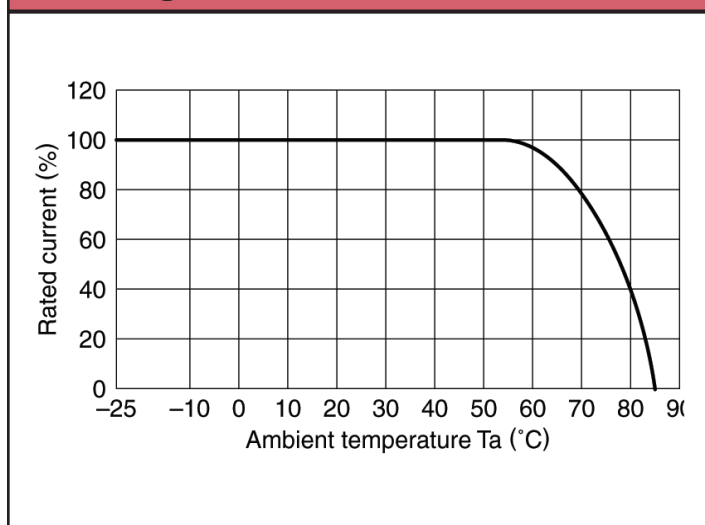

### Outline Drawing

RSAL-20R5/2001/2002/2003/2006W(L)

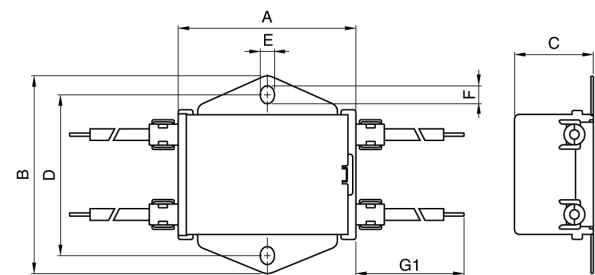

RSAL-20R5/2001/2002/2003/2006A(L)

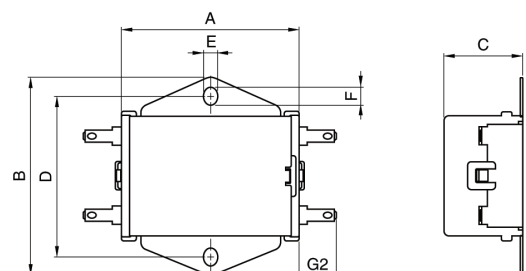

## Circuit

RSAL-2 \*\*\* W  
RSAL-2 \*\*\* A

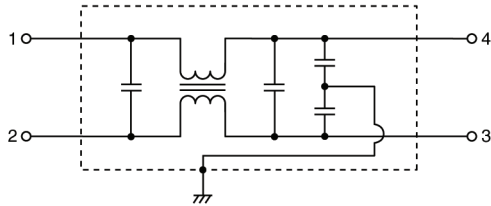

RSAL-2 \*\*\* WL  
RSAL-2 \*\*\* AL

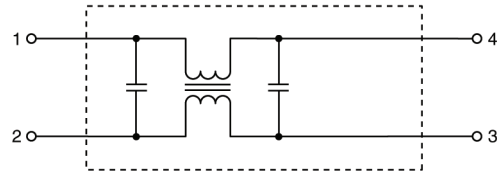

## Attenuation Characteristics

RSAL-20R5W/A

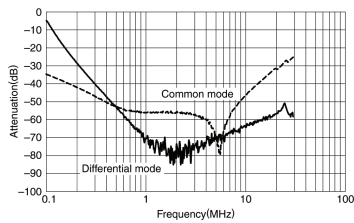

RSAL-2001W/A

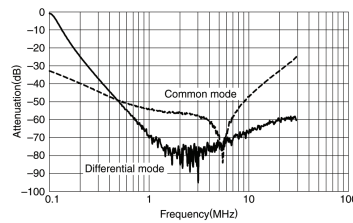

RSAL-2002W/A

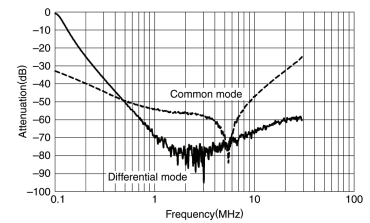

RSAL-2003W/A

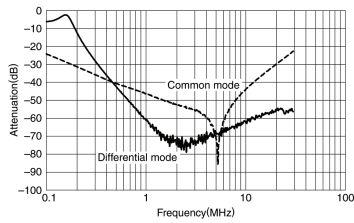

RSAL-2006W/A

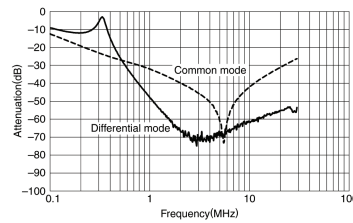

RSAL-20R5WL/AL

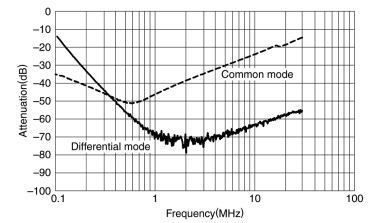

RSAL-2001WL/AL

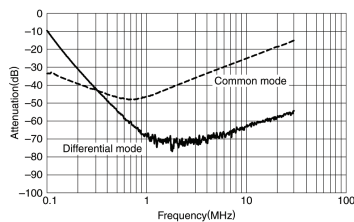

RSAL-2002WL/AL

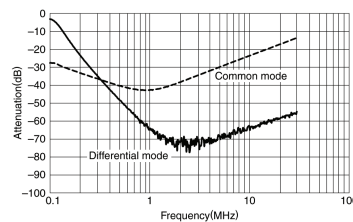

RSAL-2003WL/AL

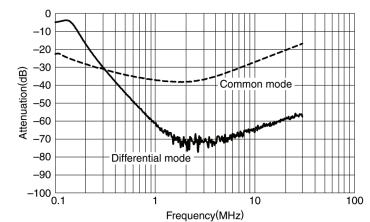

RSAL-2006WL/AL

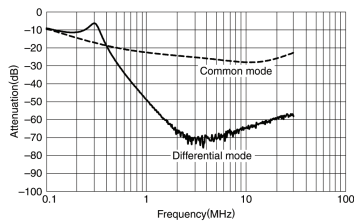

For Additional Information, please visit  
[us.tdk-lambda.com/lp/products/r-series.htm](http://us.tdk-lambda.com/lp/products/r-series.htm)

