

THIS DOCUMENT IS SUBJECT TO CHANGE WITHOUT NOTICE. IT IS CONFIDENTIAL AND A PROPERTY OF AMPHENOL LTW. DISCLOSURE TO THIRD PARTY HAS TO BE AUTHORIZED BY AMPHENOL LTW.

REV.	ECN NO.	DATE	SIGN	DESCRIPTION

ALTW
CONFIDENTIAL
 2012-05-23
R&D DEPT.

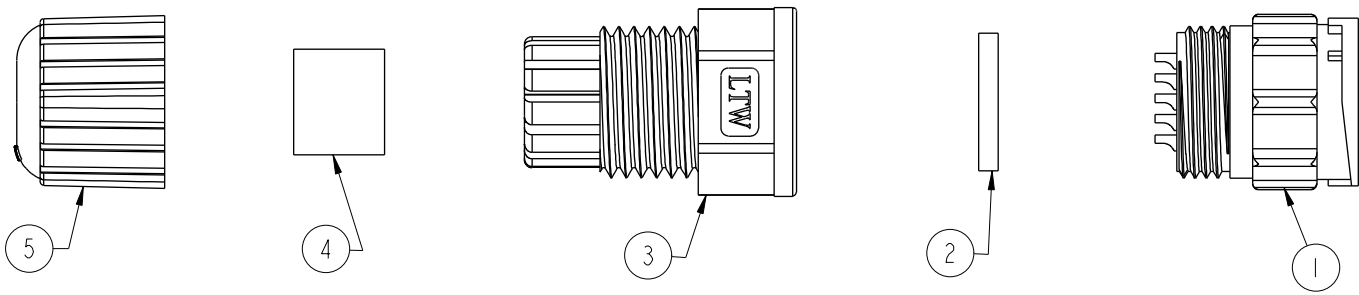

ALTW
DCC. DEPT.
CONFIDENTIAL
 2012-06-22
ISSUED

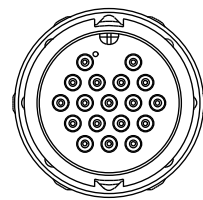
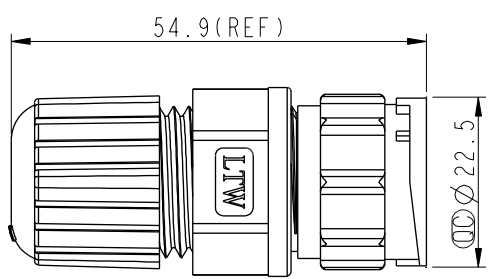

Conn

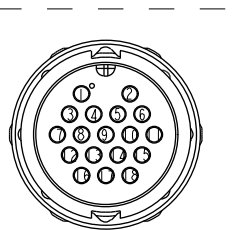

Pin Assignments
 Front View

Note:

- * \varnothing Important Dimension To Check.
- * Waterproof Rate: IP67
- * Housing: Black, Nylon+GF
- * Pin: Copper Alloy, Gold Plated
- * Gasket: Black, Silicone
- * Clamp Ring: Black, Nylon+GF
- * Sealing Nut: Black, EPDM
- * Seal: Black, EPDM
- * Seals For Cable OD: \varnothing 5.5mm~10.8mm

UNIT:mm		
TOLERANCE		
.X	± 0.25	
.XX	± 0.1	
.XXX	± 0.05	
ANGLES	$\pm 1^\circ$	

TITLE Assy Lock 18Pin M Conn M Pin			
SCALE 1:1	SIZE A4	SHEET 1 OF 1	
REV. A	WC-REV. A.2	\varnothing : Inspection item	

Amphenol LTW
 安費諾亮泰企業股份有限公司

ITEM NO. DD-18BMA-LL7001	DRAWN BY SamChang	DATE 2012-05-23
DWG NO. DD-18BMA-LL7001	CHECKED BY Jeffrey	DATE 2012-06-22
CUSTOMER ALTW	APPROVED BY Lion	DATE 2012-06-22