

THIS IS ISSUED IN STRICT CONFIDENCE THAT IT IS NOT USED AS A BASIS FOR MANUFACTURE OR SALE AND THAT IT IS NOT COPIED, REPRINTED OR DISCLOSED TO A THIRD PARTY EITHER WHOLLY OR IN PART WITHOUT THE PRIOR WRITTEN CONSENT OF CAL TEST ELECTRONICS, INC.

- DO-IT-YOURSELF (DIY) 4mm RETRACTILE SLEEVE STACKING BANANA PLUG, SCREW ATTACHMENT
- SPECIFICATIONS:
 INSULATOR BODY: POLYAMIDE (NYLON)
 PLUG BODY: BRASS, NICKEL PLATED
 CONTACT SPRING: BERYLLIUM COPPER ALLOY, NICKEL PLATED
- RATING:
 IEC: <33 V AC / <70 V DC
 VOLTAGE: 1,200 V NON-HANDHELD
 CURRENT: 36 A MAX.
 TEMPERATURE: -20° C TO +80° C.
- MAXIMUM WIRE SIZES:
 CONDUCTOR: \varnothing .090 (12AWG)
 INSULATION: \varnothing .156 (5/32")
 STRIP LENGTH: .25 (6.4)

REVISIONS			
REV.	DESCRIPTIONS	DATE	APPROVED
-	CLASS A RELEASED	7/12/99	
A	UPDATED FORMAT w/ CAGE CODE	4/18/04	

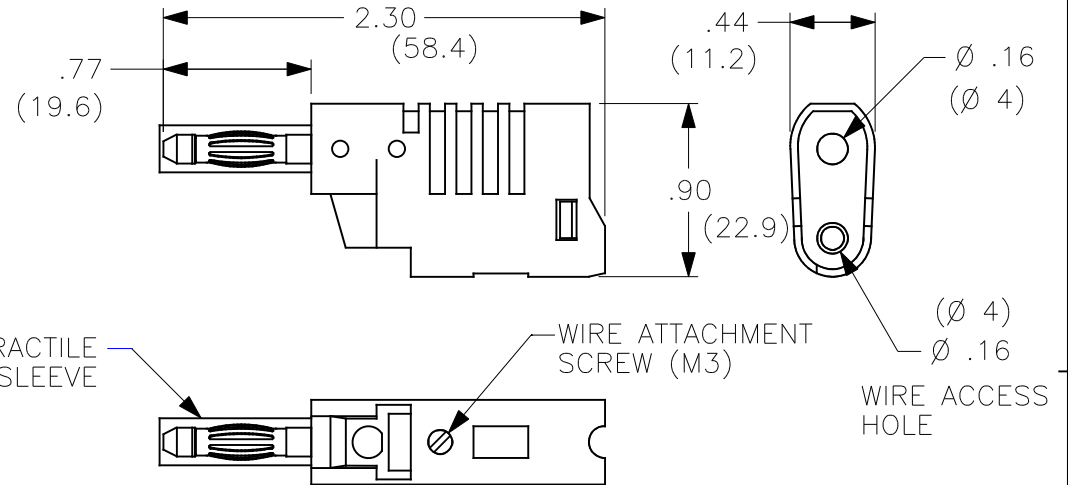

MODEL NUMBER

CT2015-#

- COLOR:
- 0 - BLACK
 - 2 - RED
 - 4 - YELLOW
 - 5 - GREEN
 - 6 - BLUE
 - 9 - WHITE

THIRD ANGLE PROJECTION		UNLESS OTHERWISE SPECIFIED DIMENSIONS ARE IN INCHES TOLERANCES ARE: FRACTIONS DECIMALS $\pm 1/32$.XX $\pm .02$.XXX $\pm .005$ DO NOT SCALE DRAWING	CONTRACT NO.		Cal Test Electronics 22820 Savi Ranch Parkway Yorba Linda, CA 92887-4610				
			APPROVALS	DATE	TITLE				
MATERIAL		DRAWN	WDH	7/12/99		DIY 4mm RETRACTILE PLUG, SCREW ATTACHMENT			
FINISH		CHECKED			SIZE	CAGE CODE	DWG. NO.	REV.	
NEXT ASSY		ENGR.			A	43F45	P201500	-	
USED ON		DESIGN ACTIVITY			SCALE	1:1		SHEET	
APPLICATION								1 OF 1	